

# **VOELLER HYDRAULIC H-200 MUD-JACK<sup>®</sup>**

**RESTORING CONCRETE SLAB  
TO ORIGINAL GRADE HAS NEVER  
BEEN EASIER OR MORE COST EFFECTIVE**

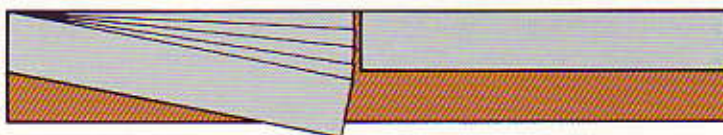

# IT'S THE VOELLER HYDRAULIC H-200 MUD-JACK®

AND RESTORING CONCRETE SLAB TO ORIGINAL  
GRADE HAS NEVER BEEN EASIER OR MORE COST EFFECTIVE



**V**oeller, the manufacturer of the original Mud-Jack, brings you an exciting new design. It's the all-hydraulic H-200 Mud-Jack, a completely self-contained system that saves time and restores your sunken concrete slab to its original grade faster and with less disruption than ever before.

This H-200 Mud-Jack system eliminates the hazard and potential liability problems of sunken slabs quickly. You don't have the high cost, delays or the inconvenience encountered with the reconstruction process.

The H-200's compact size enables you to set-up, charge, mix and pump material with greater ease and speed than has been possible. The end result is a firm, solid base that extends the useable life of concrete construction without any appreciable downtime and at a reasonable cost. The system can be used to raise concrete slabs on streets, bridge approaches, curbs, gutters, driveways, sidewalks, pool decks, patios, garage and basement floors... anywhere slab has slipped due to the settling of base materials.



## EXCEPTIONAL HYDRAULIC EFFICIENCY

The H-200 is an all-hydraulic machine. There are no mechanical drive parts to service and maintain or create problems that slow projects. The hydraulic system has been provided with a remote variable speed control. A convenient, hand held, electric, dead man control switch on a 30 foot cable permits you to vary the speed of the pumping piston (0 to 13 strokes per minute)—high speed to fill voids and low speed for final lifting. The maximum output is approximately 225 cu. ft. per hour.

## COMPACT, CLEAN DESIGN

The Voeller H-200 has been designed to make servicing easy. There is ample working space for making engine checks, inspection of the hydraulic system and performing all routine service functions. You'll like the open design and how easy it is to keep the machine clean.

## HIGH PERFORMANCE MUD PUMP AND CYLINDER

A high-performance variable speed mud pump is used in the H-200. It has a single piston with rubber piston ring and shims, inlet valve and a 500 cubic inch nickel-lined mud chamber.



## THOROUGH MIXING MAKES MUD-JACKING EASIER

The H-200 has a paddle-type mixer that provides continuous flow through mixing. Its 54" long, 16" wide, 24" deep material hopper keeps the charging routine easy and simple. Mixing shaft has sealed anti-friction bearings, independent packing glands and replaceable mixing blades.



## D I M E N S I O N S

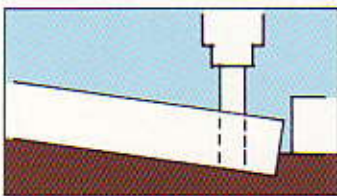
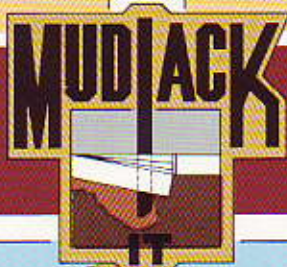
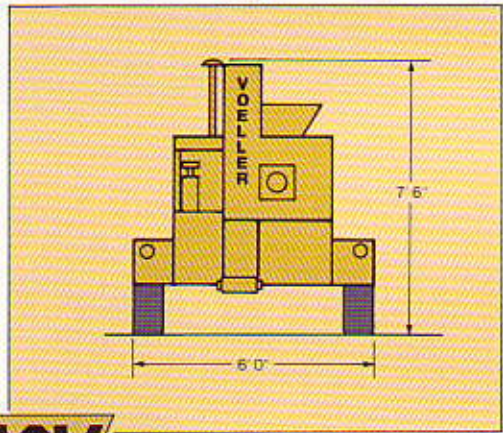
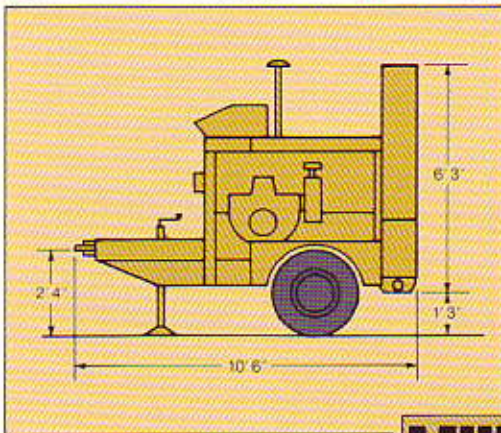

You drill a series of holes in the sunken slab at selected locations. The holes are used for pumping in the mud mixture.

**A**

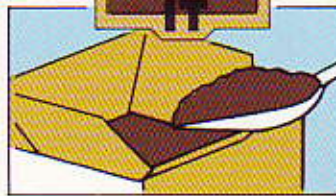

Mud materials are loaded into the H-200 Mud-Jack for mixing. The preferred mixture is a good loam topsoil, cement, fly ash and water (relatively free of sand, clay and pebbles).

**B**

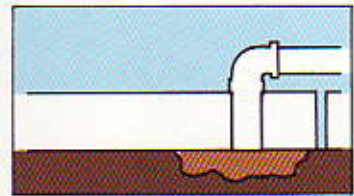

Material is pumped into the holes. Hydraulic pressure raises the slab to the original grade. Easy does it!

**C**

# VOELLER

## H-200 MUD-JACK® SPECIFICATIONS

### General:

Approximate Weight	4,900 lbs.
Engine	35 hp. air-cooled gasoline engine with electric start.
Mixer	Paddle type. Mixing shaft has sealed anti-friction bearings, independent glands and replaceable mixing blades.
Discharge System	Self-cleaning, floating ball type valve. 25' x 3" discharge hose with 2½" diameter discharge nozzle and operator's platform.
Operating Control	Remote, variable speed control. 12 volt electric hand-held deadman type control with 30' of cable.
Flexible Coupling	Connects engine and hydraulic system. Has neoprene inserts. Absorbs shock loading.

Gas Tank: 13 Gallons

Tires: Two LT235/85R16 10-ply rated  
Suitable for towing at highway speeds.

Brakes	Mechanically actuated hydraulic surge type with automatic breakaway with safety chains.
Towing Tongue	Has 3" lunette eye and leveling jack.
Water System	Self priming 40 gpm water pump powered by 6 gpm hydraulic motor, piping, operating valve and hoses, 25' x 1¼" water suction hose and strainer.

### Hydraulics:

Pump	24 gpm piston type.
Motor	10 gpm — operates mixer shaft.
Cylinder	Heavy-duty type — easily removable along with mud piston assembly by pulling pivot pin.
Reservoir Capacity	110 gallons.
Relief Valve	Non-adjustable relief valve preset to bypass at 1500 psi.
Filtration	Return and suction line oil filters with replaceable elements.
Mud Pump and Cylinder	Single 10½" stroke piston. Cylinder has 7⅞" bore, 500 cubic inch displacement. Nickel-lined mud chamber.

### Options:

- Two-way valve and operating parts for two hose operation
- Additional mud hose: 25' x 3" hose with connecting parts
- Electric hour meter
- Extra control cable for control box
- Special paint



### VOELLER HYDRAULIC H-20 MUD-JACK

The Voeller H-20 is a small capacity Mud-Jack that moves up to 4 cubic yards of material per hour. It has a highly efficient, 8 hp air-cooled gasoline engine and uses a 6 gpm pump that supplies oil at 1500 psi pressure to operate the on/off valve, stroke speed valve and pumping piston. Speed is manually variable.

### Dimensions and weight

Height	55 inches
Width	25¼ inches
Length	70 inches
Charging Height	35 inches
Hopper Capacity	5 cubic feet (approx.)
Weight	500 lbs. (approx.)



We reserve the right to amend these specifications at any time without notice. The only warranty applicable is our standard warranty. We make no other warranty, expressed or implied.

Voeller, Inc.  
455 N Moore Road P O Box 325  
Port Washington, WI 53074-0325  
Phone: 262-284-3114 Fax: 284-3116  
E-Mail: voellmix@execpc.com